



TOTAL EXTENT (LEAST EXTENT AS PER PATTI) : 11000 SQ.M ✓
ROAD AREA : 2144 SQ.M ✓
PARK AREA : 887 SQ.M ✓
PUBLIC PURPOSE PROVIDED (1) : 891 SQ.M ✓
REGULAR PLOTS : 24 Nos. ✓
E.W.S. PLOTS (995 SQ.M) (25 TO 40) : 16 Nos. ✓
TOTAL NO.OF.PLOTS : 40 Nos. ✓
COMMERCIAL SITE : 1 No. ✓

NOTE:

- 1.SPLAY - 1.5M X 1.5M
- 2.MEASUREMENTS ARE INDICATED EXCLUDING SPLAY DIMENSION
3.  ROAD AREA WERE HANDED OVER TO THE LOCAL BODY
 PARK AREA VIDE GIFT DEED DOCUMENT NO. 9821/2019, DATED: 03.09.2019, @ SRO CHENNAI SOUTH JOINT-I

CONDITIONS :

(I) DR RULE NO: 29 (8)
THE AREA EARMARKED FOR PUBLIC PURPOSE PLOT VIZ. POST AND TELEGRAPH OFFICE, POLICE STATION ETC.) WOULD REMAIN RESERVED FOR A SPECIFIC PERIOD OF ONE YEAR FROM THE DATE OF APPROVAL TO ENABLE THE GOVERNMENT DEPT. CONCERNED TO NEGOTIATE WITH THE OWNER AND ACQUIRE THE RESERVED LAND IF REQUIRED FOR THEM. THE COST OF THE PLOT SHOULD NOT BE MORE THAN GUIDE LINE VALUE. IF THE PROMOTER ADDS PROPORTIONATE DEVELOPMENT COST ON THE PRICE OF THE PUBLIC PURPOSE PLOT, THE SAME SHOULD BE APPROVED BY CMDA.

(II) DR RULE NO: 29 (9)







THE OWNER OR DEVELOPER OR PROMOTER SHALL SELL THE EWS PLOTS ONLY FOR EWS PURPOSE. NO CONVERSION OR AMALGAMATION SHALL BE PERMISSIBLE IN THE CASE OF EWS PLOTS.

(III) DR RULE NO: 29 (11)

THE COST OF LAYING IMPROVEMENTS TO THE SYSTEMS IN RESPECT OF ROAD, WATER SUPPLY, SEWERAGE, DRAINAGE OR ELECTRIC POWER SUPPLY THAT MAY BE REQUIRED AS ASSESSED BY THE COMPETENT AUTHORITY, SHALL BE BORNE BY THE APPLICANT.

© NECESSARY SPACE FOR BUILDING LINE TO BE LEFT AS PER THE RULE IN FORCE WHILE TAKING UP DEVELOPMENT IN EVERY PLOT.

LEGEND :

-  SITE BOUNDARY ✓
-  ROADS GIFTED TO LOCAL BODY ✓
-  EXISTING ROAD ✓
-  PARK GIFTED TO LOCAL BODY ✓
-  PUBLIC PURPOSE ✓
-  E.W.S ✓
-  COMMERCIAL ✓

CONDITION:-
THE LAYOUT APPROVAL IS VALID SUBJECT TO OBTAINING SANCTION FROM THE LOCAL BODY CONCERNED

P.P.D NO. **111**
L.O **2019**

APPROVED

VIDE LETTER NO : L1/17425/2018
DATE : 18/10/2019

FOR MEMBER SECRETARY
CHENNAI METROPOLITAN
DEVELOPMENT AUTHORITY

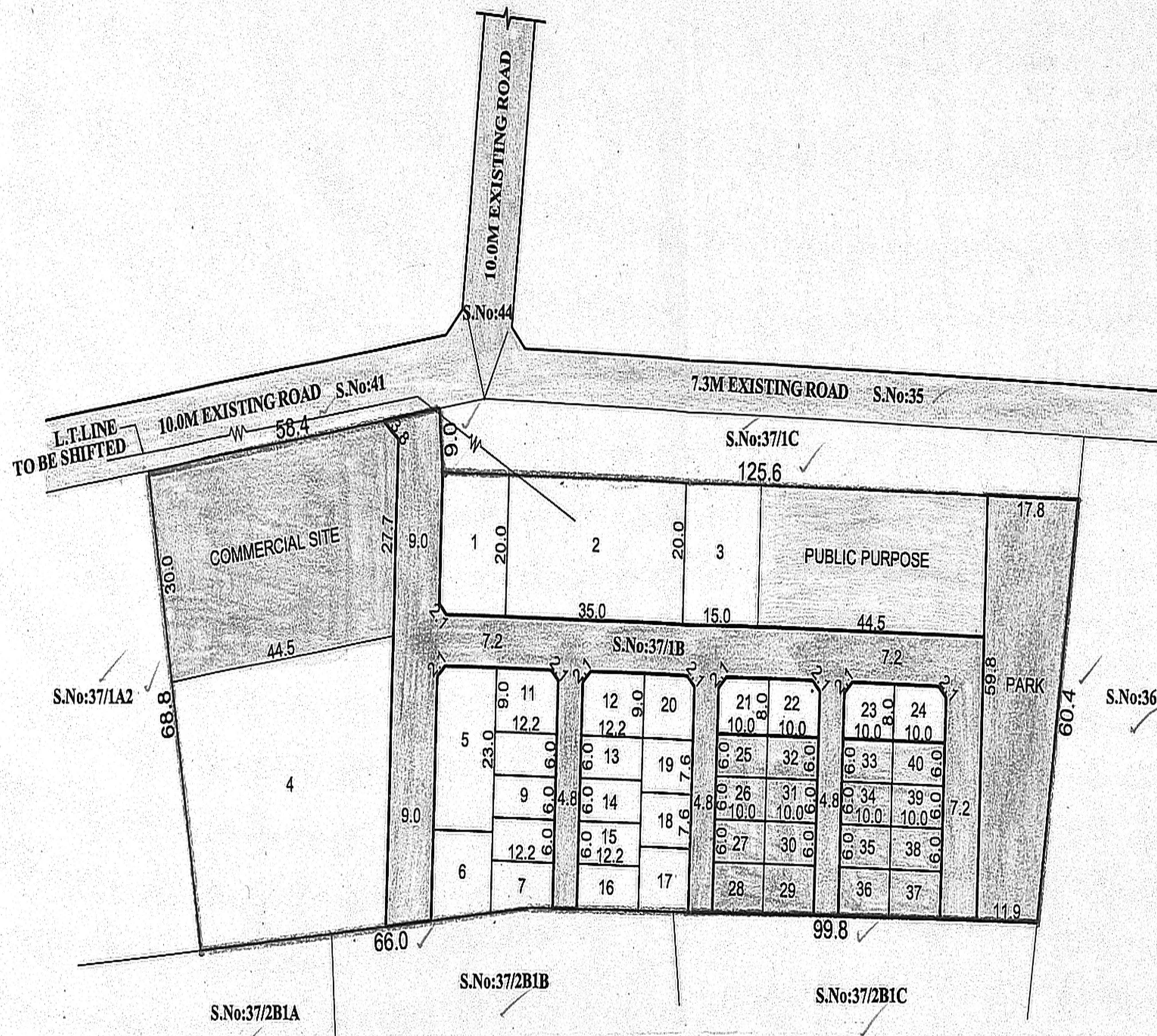

PREPARED BY: *S. Ananda* 18/10/19
P.A.I
A.P. *[Signature]* 18/10/2019

GREATER CHENNAI CORPORATION, ZONE - XII
LAYOUT OF HOUSE SITES IN S.No: 37/1B OF MANAPAKKAM VILLAGE.
SCALE - 1:800 (ALL MEASUREMENTS ARE IN METRE)

